

HALFMOON WALL SCONCE FIXTURES

- ADA COMPLIANT MODELS
- PRE-WIRED, INDIVIDUALLY BOXED, NO ASSEMBLY REQUIRED

SPECIFICATIONS

- UL LISTED FOR DAMP LOCATIONS
- INCANDESCENT MODELS 120V; FLUORESCENT MODELS 120V NPF
- WHITE POWDERCOATED STEEL BASE AND ACRYLIC DIFFUSER
- STANDARD PACK QTY: 10 MOQ: 300 LEAD TIME: 90-120 DAYS



LOW PROFILE HALF MOON

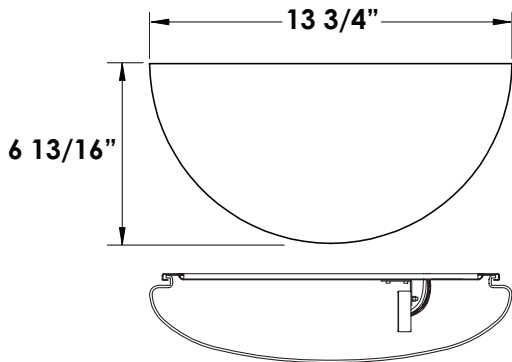

EXTENDS: 3 5/16"
HCMT: 4 3/8"

DEEP WELL HALF MOON

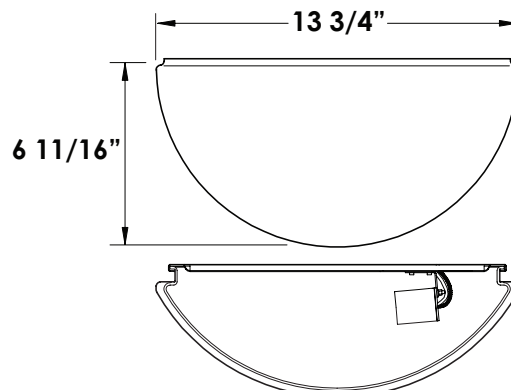

EXTENDS: 5"
HCMT: 4 3/8"

EXAMPLE # **FD311-M213-WW**

STYLE #	WATTAGE	COLOR
FM101 = LOW PROFILE FM102 = DEEP WELL	LOW PROFILE & DEEP WELL MODELS G13 = 1-13W GU-24 LAMP INCLUDED (ELECTRONIC) * G213 = 2-13W GU-24 LAMPS INCLUDED (ELECTRONIC) * G18 = 1-18W GU-24 LAMP INCLUDED (ELECTRONIC) * M13 = 1-CFT13W/GX23 LAMP (MAGNETIC) M213 = 2-CFT13W/GX23 LAMPS (MAGNETIC) E13 = 1-CFQ13W/G24q LAMP (ELECTRONIC) * E213 = 2-CFQ13W/G24q LAMPS (ELECTRONIC) * DEEP WELL MODELS ONLY I100 = 1-100W MEDIUM BASE INCANDESCENT	WW = WHITE W/WHITE DIFFUSER

* ENERGY STAR COMPLIANT WHEN USED INDOORS

AVAILABLE AS SPECIAL ORDER

For more information regarding Inter-Global's Assembled Fixtures and Private Labeling please contact our sales department at **1-800-325-7364** or visit www.interglobal-inc.com

Specifications subject to change without notice. Printed in U.S.A. © 2011 Inter-Global Inc.



1101.1

D3